

REV.	NOTES	DATE
A	RELEASED	2019/07/11
B	新增产品料号	2020/05/28

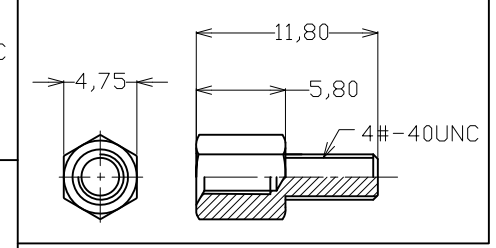

NOTES:
 1.MATERIAL
 1.1 INSULATOR:PBT+30%Glass Fiber BLACK
 1.2 CONTACT BRASS
 1.3 CONTACT PLATED:GOLD/TIN PLATED
 1.4 SHELL:STEEL,NICKEL PLATED

2.SPECIFICATION
 2.1 CURRENT RATE:5 AMPS
 2.2 INSULATOR RESISTANCE: 1000M Min AT 500V DC
 2.3 DIELECTRIC STRENGTH: 1000V PER MINUTE
 2.4 OPERATION TEMPERATURE:-40°C TO +85°C

To prepare:

PART NO.	RIVETING STRUCTUER	SCREW	CONTACT PLATING
AA02+0901-2080	铆合不附螺絲		GOLD/TIN PLATED
AA02+0902-2080	铆合鎖螺絲	4.8*11.8	GOLD/TIN PLATED
AA02+0903-2080	叉鎖鎖螺絲	4.8*11.8	GOLD/TIN PLATED
AA02+0904-2080	铆合附螺絲	4.8*11.8	GOLD/TIN PLATED
AA02+0905-2080	铆合附螺絲	5.8*12.8	GOLD/TIN PLATED
AA02+0906-2080	铆合鎖螺絲	5.8*12.8	GOLD/TIN PLATED
AA02+0907-2080	铆合附螺絲	5.8*11.8	GOLD/TIN PLATED
AA02+0908-2080	铆合鎖螺絲	5.8*11.8	GOLD/TIN PLATED

DIMENSIONS TOLERANCE METRIC
 .0= ± .38
 .00= ± .25
 .000= ± .15
 .0000= ± .
 ANG.= ± 2°

單位(UNITS)	mm	東莞翊豐精密五金有限公司							
數量(QT'Y)	N/A								
材料(MT'L)	SEE NOTE								
處理(FINISH)	SEE NOTE								
繪圖(DRAW)		圖名(NAME) D-USB 9P母 8.1 系列 RoHS							
設計(DE'N)		料號(PART NUMBER)		AA02+090X-2080					
審校(CH'K)		圖號(DRAW NUMBER)		RAA02090X2080					
核准(APP'D)		圖檔(FILE NAME .DWG)							
		比例(SCALE)	1/1	圖紙(SIZE)	A4	頁次(SHEET)	1/2	版次(REV.)	B

P.C.B. LAYOUT(TOLERANCE:±0.05)
TOP VIEW