

▨ : STAND OFF AREA
 TOLERANCE: ±0.05
 RECOMMENDED PCB LAYOUT
 (TOP VIEW)

LTR	Part Name	Material	Description	QTY
1	Housing	LCP UL94V-0	+30%GF 260°C for 10 Seconds. Initial : 1000M Ohms Min.	1
2	Contact	Brass C2680	Current Rating : 0.5 A Initial : 30m Ohms Max.	40
3	Fitting Nail	Brass C2680	Current Rating : 0.5 A Initial : 30m Ohms Max.	2
4	CAP	LCP	20pin規格以上才用	1

Temperature Rating : -40°C ~ +105°C .
 Dielectric Withstanding Voltage : 300 V AC/Min

單位(UNITS)	mm	東莞翊豐精密五金有限公司
數量(QTY)	N/A	
材料(MTL)	SEE NOTE	
處理(FINISH)	SEE NOTE	
繪圖(DRAW)		圖名(NAME) PH0.8 BTOB H1.4 母座成品圖 ROHS
設計(DE'N)		料號(PART NUMBER) AABT+080XXP-BACA
審核(CH'K)		圖檔(FILE NAME .DWG)
核准(APP'D)		比例(SCALE) 1/1 圖紙(SIZE) A4 頁次(SHEET) 1/2 版次(REV.) A

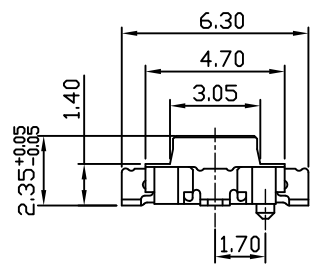
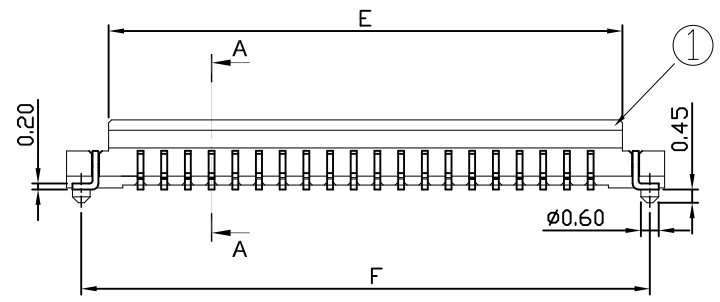

AABT+080XXP-BACA
 NO. OF CONTACT CODE

此款PIN位太小，無法加CAP帽包裝。

Circuit No.	Dimensions					
	A	B (A+5.0)	C (A+1.0)	D (A+1.6)	E (A+2.15)	F (A+4.0)
2*6P	4.00	9.00	5.00	5.60	6.15	8.00
2*10P	7.20	12.20	8.20	8.80	9.35	11.20
2*15P	11.20	16.20	12.20	12.80	13.35	15.20
2*20P	15.20	20.20	16.20	16.80	17.35	19.20

DIMENSIONS TOLERANCE METRIC	
X	: ±0.5
X.X	: ±0.38
X.XX	: ±0.25
ANGLES	
X	: ±1°
X.X	: ±0.5°